

GUARD TOUR MANAGEMENT SYSTEM USER'S MANUAL

WM-5000P4D



WM-5000P4D Guard Tour System User's Manual

1. What is guard tour system?

A guard tour system is a system used to help companies and organizations to organize, log and execute guard tours and patrols in their assets ensuring that the officers will accomplish their tasks within the predefined time intervals. There is a wide variety of guard tour systems, which can be divided in two major categories: Wand guard tour systems based on handheld devices and cloud guard tour systems based on modern mobile and cloud technology. Guard tour systems provide a means to check and record the time that a guard executes his guard tour by scanning specific checkpoints assigned on the area he patrols.



2. Applications

- warehouse systems
- improving rent a car systems
- monitoring proper service
- supervising personnel work time and place
- monitoring scheduled technical maintenance
- supervising guards
- supervising service producers
- supervising drivers
- monitoring rent systems
- airport protection and supervising workers
- hotel protection and supervising workers
- protection for other public institutions

3. Functional Diagram





4. Prompt: Basic Function

Working Prompts	
Power on	Red LED flashes one second and vibrates once. Screen: JWM logo Voice: Make Patrol Easier
Power off	Vibrates once Screen: POWER OFF Voice: Power off
Internet Registration	Registering Internet registration automatically when power on. Screen: REGISTERING Voice: Registering Blue LED flashes once per second.
	Registered successfully Screen: RREGISTER OK Voice: Register successfully Device vibrates once, blue LED turns off
	Registration failed Screen: REGISTER FAILED Voice: Register failed Vibrates 3 times, blue LED turns off
Standby	Green LED flashes once every 3 seconds.
Low power	Red LED flashes once every 3 seconds.

5. Prompt: GPS Function

Working Prompts		
GPS Position	GPS Positioning	Device automatically position after power on
	Positioning Successfully	Red LED flashes once per second Screen: GPS Icon
	Arrived GPS position	Vibrates once Screen: ARRIVED Voice: Arrived patrol location Play voice event if generate <ul style="list-style-type: none"> • Sending data directly if internet register successfully • Record data if no SIM card inside
	Track Data	Blue LED solidss on Upload successfully: Blue LED flashes five times and turns off Upload failed: Blue LED turns off directly
	Collecting GPS Position	Long press function button, device vibrates once Screen: GPS COLLECTING Voice: Collecting GPS locations Collect successfully: Screen: SUCCESSFULLY Voice: Collect successfully Then device goes to upload data Collect failed: Screen: FAILED Voice: Collect failed

6. Prompt: Phone Call Function

Working Prompts		
Phone Call	Contact Switching	<p>Device in standby mode, press call button Vibrates once. Screen: Contact information Press call button for switching another If no contact Vibrates 3 times Screen: NO CONTACTS Voice: No contact</p>
	Dial	<p>In contact information interface, hold button for 3 seconds Vibrates once SCREEN: DIALING The call is answered: Screen: CONNECTING The call is not answered or be hang up: Vibrates once Screen: CALL ENDED</p>
	Incoming Call	<p>Vibrates once Screen: Contact name or UNKNOWN CONTACTS Device rings and LED flashes till the call is ended</p>
	Missed Call	<p>Vibrates once Screen: MISSED CALL Voice: Missed Call</p>

7. Prompt: Power and Data Upload

Working Prompts	
Charging	Red LED solidsss on
Full charge	Green LED solidsss on
Upload Patrol Data	<p>Screen: UPLOAD; Voice: Uploading; Blue LED solidsss on</p> <p>Upload Successfully: Vibrates once Screen: UPLOAD OK Voice: Data uploaded successfully Blue LED flashes 5 times and turns off</p> <p>Upload Failed: Vibrates 3 times Screen: UPLOAD FAILED Voice: Data Uploaded Failed Blue LED turns off</p>
Upload Low Power Data	<p>Screen: Low Power; Voice: Low battery, charge please; Blue LED solidsss on</p> <p>Upload Successfully: Vibrates once Screen: UPLOAD OK Voice: Data uploaded successfully Blue LED flashes 5 times and turns off</p> <p>Upload Failed: Vibrates 3 times Screen: UPLOAD FAILED Voice: Data Uploaded Failed Blue LED turns off</p>
Upload Alarm Data	<p>Screen: ALERTING; Voice Alerting now; Blue LED solidsss on</p> <p>Upload Successfully: Vibrates once Screen: SUCCESS Voice: Alerting successfully Blue LED flashes 5 times and turns off</p> <p>Upload Failed: Vibrates 3 times Screen: FAILED Voice: Alerting Failed Blue LED turns off</p>





8. Prompt: Read Checkpoint

Working Prompts	
Clock error	<p>Vibrates 3 times</p> <p>Screen: TIMING PLS</p> <p>Voice: The clock is wrong, please timing</p>
Read Checkpoint Successfully	<p>Vibrates once</p> <p>Screen: SUCCESS</p> <p>Voice: Reading successfully</p> <p>Play voice event if generate</p> <ul style="list-style-type: none"> • Sending data directly if internet register successfully • Record data if no SIM card inside
Data storage error	<p>Vibrates 4 times</p> <p>Screen: STORAGE ERROR</p> <p>Voice: Stored Failed</p>
Low Storage	<p>When the record stored more than 50,000, read again:</p> <p>Vibrates two times</p> <p>Screen: SUCCESS, DATA FULL</p> <p>Voice: Reading successfully, please Upload Now</p>
Data Full	<p>When the record stored is 60,000, read again:</p> <p>Vibrates 6 times</p> <p>Screen: DATA FULL</p> <p>Voice Shows: Store failed under sufficient storage</p>

9. Technical Specification

Model	WM-5000P4D
Physical Material	Metal body with silicon shell outside
Dimensions	120mm*68mm*32mm
Weight	221g
Reading Type	RFID
Reading Frequency	125KHz
Reading Distance	125KHz card: 3-5cm
Operation Temperature	-20°C to +85°C
Storage	60,000 pieces
Memory	32Mb Flash ROM
Protection Level	IP67
Charging time	1.5 hours
Battery	3.7V Lithium Recharge Battery
Standby Time	19 Hours (Sending data for 15s intervals)
Communication	USB 2.0 (Drive-Free); 12,000 record uploading/min
Humidity	10% to 90%

RFID checkpoints

Model	Checkpoint	Frequency	Dimensions	Weight
WM-28B		125kHz	6.6mm*27.7mm	1.7g
WM-226		125kHz	36mm*28mm*6mm	3.8g
WM-30A		125kHz	30mm*4mm	2.8g
WM-70A		125kHz	76mm*56mm*10mm	19g
WM-70Y		125kHz	76mm*56mm*10mm	19g

10. System Components

- 1) WM-5000P4D reader
- 2) USB Cable
- 3) Standalone Software
- 4) Charger
- 5) Holster
- 6) Checkpoints (optional purchase)
- 7) Guard ID Tags (optional purchase)

11. User Flow

- 1) Make a sketch of the checking places that the guard needs to check.
- 2) Install checkpoints on each checking place.
 - *The round shape checkpoint can be stuck or screwed on the wall.
 - *For the cylinder glass checkpoint, make a hole in the wall, and then put it inside and cover it.
- 3) Install software and make settings in software
- 4) The guard uses the reader to starts to patrol, he needs go to each checking place and uses the reader to scan checkpoints installed on the wall.
- 5) The guard will press the reader left button for sending data (or send data automatically) to the control center. The reader also can

Installation

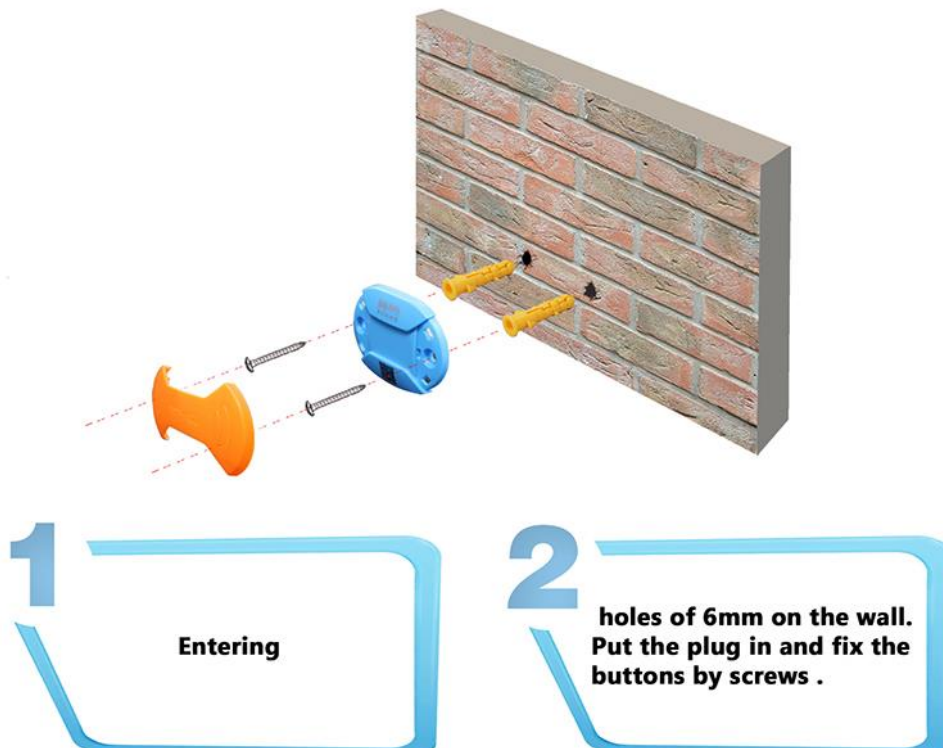

How to collect GPS position ?

- The security guard take the WM-5000P4D reader outside.
- Guard arrives the GPS checking place where he wants to patrol, Long press the function button
- Device vibrates once. Screen: GPS COLLECTING
Voice: Collecting GPS locations
- If Collection is successful:
Screen: SUCCESSFULLY Voice: Collect successfully
Device goes to upload data
- If Collection is failed:
Screen: FAILED Voice: Collect Failed

Note : Once GPS checkpoint collection will take 30 seconds, please be patient.



12. Warranty Policy

- (1) All products are strictly tested and qualified before sale.
- (2) Hardware devices sold by our company are covered by 5 Year parts warranty.
- (3) During 5 Year warranty period, we will replace or repair units without charge, subject to any problem coming from product itself under ordinary usage condition. The 5 Year warranty period begins when the new products are received by customer. We warrant its remanufactured products and non-warranty repair to hardware from defects in material and workmanship for a period of 90 days. The 90 days warranty period begins the date when repair or remanufactured product is shipped from us.
- (4) This warranty does not apply on batteries and extra parts. This warranty is invalid if the product has been damaged by accident, abuse, misuse, product end of life, or misapplication or has been dismantled or repaired without the written permission of our company.
- (5) In any condition, freight will be paid by customer.

Thank you so much for choosing our guard tour system! If you have any question on our product, please feel free to contact us or local dealer and we still try our best to help you!



JWM Hi-Tech Development Co., Ltd

TEL: 0086 24 83782790

Email: sales@jwm-rfid.com

support@jwm-rfid.com

Web: <http://www.jwm-rfid.com>